

a 46-32

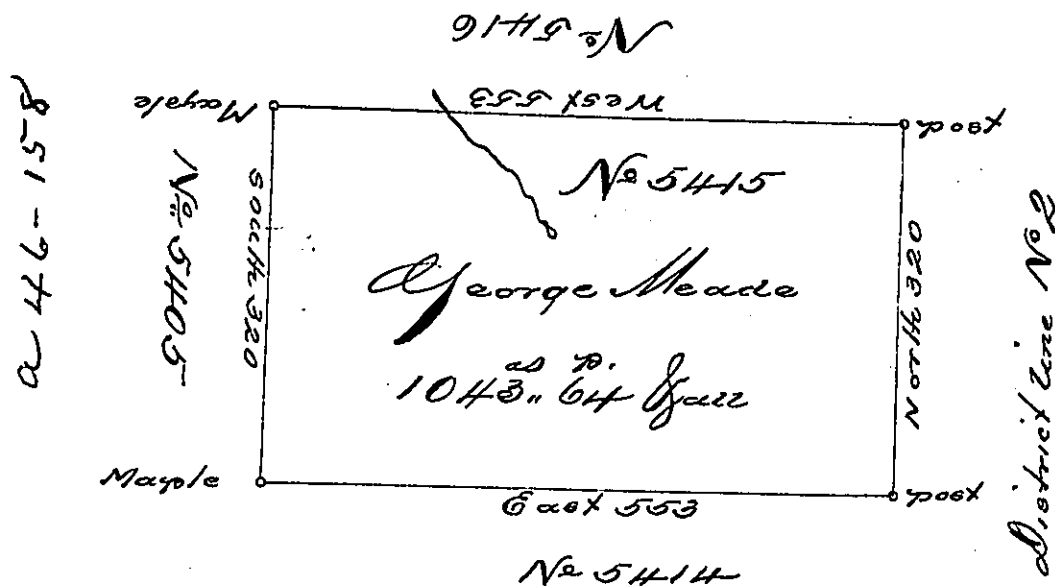

a 46-15-8

M - 275

Situate on the waters of Amnemaoning Creek in North County, containing  
 1043 acres 64 perches and the usual allowance for roads. Surveyed April 29th  
 1794 for George Meade in pursuance of a warrant No 5415, dated 3rd  
 March 1794.

Daniel Brodhead Esqr.  
*sl.*

John Canan D.S.

IN TESTIMONY that the above is a copy of the original remaining on file in  
 the Department of Internal Affairs of Pennsylvania, made  
 conformably to an Act of Assembly approved the 16th day of  
 February, 1833, I have hereunto set my Hand and caused  
 the Seal of said Department to be affixed at Harrisburg,  
 this fourth day of October, 1898,

James W. Latta  
 Secretary of Internal Affairs.